

# PR<sub>→</sub>AIM SnapRig Basic Shoulder Mount Kit (SR228)

## Assembly Manual



### ■ What's In The Box

Please inspect the contents of your shipped package to ensure you have received everything that is listed below.



Shoulder Pad

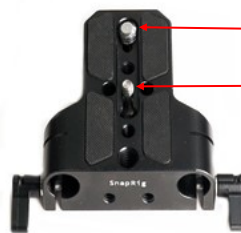

Camera Plate

Bolt (Size:3/8")

Bolt (Size:1/4")



Junction Adapter



3 x 300mm long Rod (Dia=15mm)



2 x Grip Handles

All rights reserved.

No part of this document may be reproduced, stored in a retrieval system, or transmitted by any form or by any means, electronic, mechanical, photo-copying, recording, or otherwise, except as may be expressly permitted by the applicable copyright statutes or in writing by the Publisher.

## Basic Shoulder Mount Setup

- Loosen both the knobs of the Junction Adapter and insert 300mm long rod (Dia 15mm).

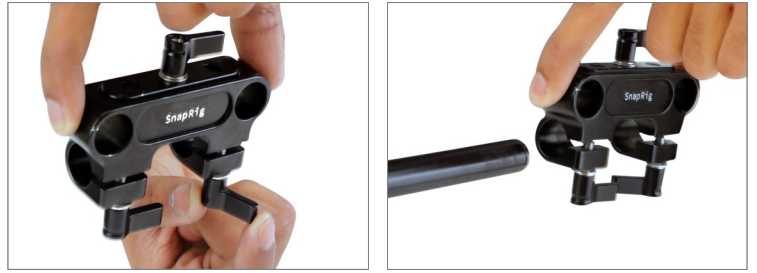

- Then properly tighten both the knobs, as shown in the image.



- Now loosen the knob of the grip handle and insert the left side of the 300mm long rod.



- Then properly tighten the knob. Repeat the same process for the other grip handle.

**NOTE:** It minimizes rotation while shooting video with your camera, making your shoulder comfortable and shots more stable.



- Now loosen the top knob of the junction adapter and insert the 300mm long rod (Dia 15mm).



- Then insert another 300mm long rod (Dia 15mm) and tighten the knob properly, as shown in the image.



- Now loosen both the knobs of the camera plate and insert the rods into the plate.

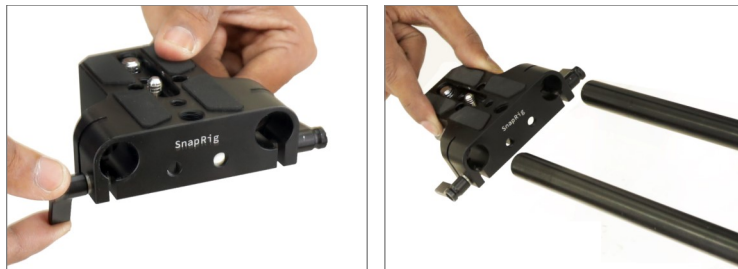

- Then properly tighten both the knobs, as shown in the image.

**NOTE:** Rubber padding on the camera base plate prevents the Camera from twisting or scratching.



- Now loosen the knob of the shoulder pad and secure it properly by inserting it into the rods.

**NOTE:** The shoulder pad has multiple 1/4"-20 threads, so you can mount other accessories too.

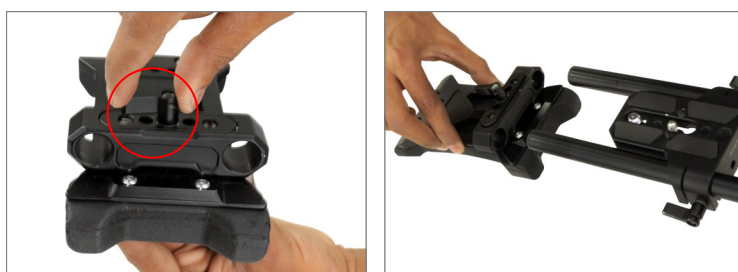

**NOTE:** The shoulder pad allows the Rig to sit comfortably on your shoulders by eliminating the discomfort caused by the Camera's weight on your shoulder during filming.

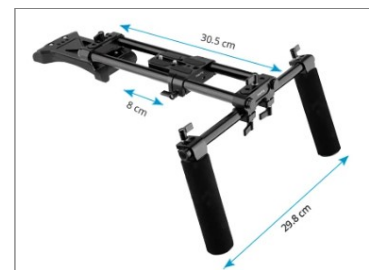

- Now loosen the knob of the shoulder pad and adjust it according to your requirement.

**NOTE:** You can tighten the rod support with this knob, offering easy and quick operation.



- Mount the Camera (Not-Included) on the shoulder pad and tighten it properly with the help of a screw driver.

**NOTE:** The Rig has a camera base plate that features multiple mounting threads for easy mounting on different plates and rigs. Also, it features a 15mm rod support and securely mounts your Camera using 1/4"-20 and 3/8"-16 camera mounting screws.



**NOTE:** Dual handgrip kit offers both comfort and balance with its two 360° rotatable handgrips that securely mount onto the rods with a 15mm rod clamp.



**YOUR PROAIM SNAPRIG BASIC SHOULDER MOUNT KIT  
ALL DRESSED UP AND READY TO GO!**



**(SHOWN WITH OPTIONAL ACCESSORIES)**

**Warranty:** We offer one year warranty for our products from date of purchase. Within this period of time, we will repair it without charge for labor or parts. Warranty doesn't cover transportation costs nor does it cover a product subjected to misuse or accidental damage. Warranty repairs are subjected to inspection and evaluation by us.

**Liability:** We are not liable for damage caused by products that we do not supply or from mishandling in transit, accident, misuse, neglect, lack of care of the product, or service by anyone other than our company.

**Contact Us:** In case of any kind of dissatisfaction, please Contact us immediately and we promise our utmost support and care until you use our product.