

weeylite

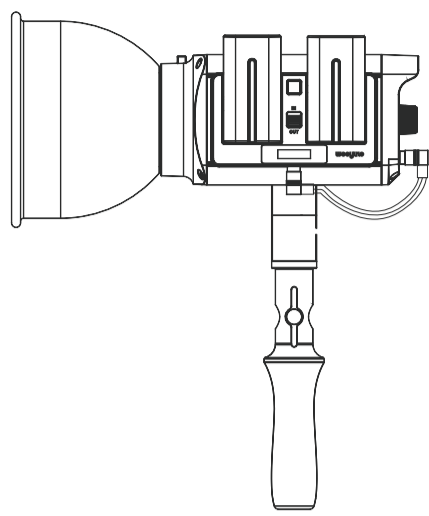

## ninja 200

专业补光灯

### 产品说明书

www.weeylite.com

## 01/产品特点

ninja 200 是一款小巧外型大功率补光灯, 采用高显色指数双色COB灯珠, 光效高, 色温准, 功率大, 外形小的特点, 完美的运用到摄影, 摄像, 演播厅, 展厅及化妆等对光源要求高的补光。

- 高显色指数双色 COB LED 灯珠。
- 小巧外形搭配60W大功率。
- 双供电系统, 锂电池或DC电源供电。
- 点阵液晶显示屏, 显示更直观。
- 优质散热风扇使LED芯片工作于较低温度, 确保更长的使用寿命。
- 多种调光方式, 主机控制/手机APP/蓝牙遥控器。

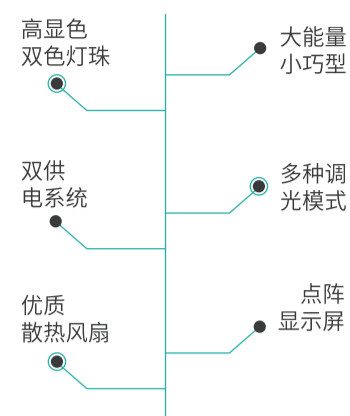

## 02/产品介绍

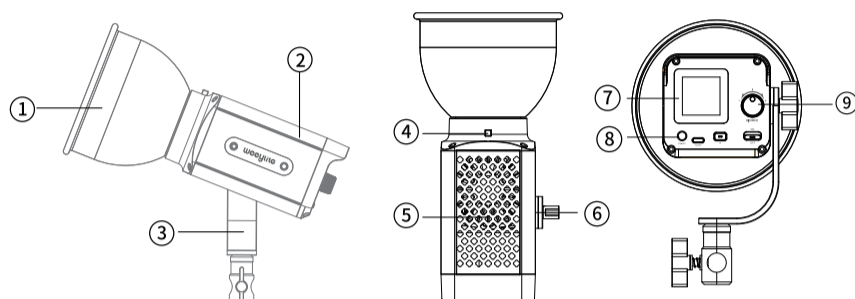

- ① 灯罩
- ② 灯体
- ③ 支架
- ④ 灯罩安装键
- ⑤ 排气扇
- ⑥ 角度调节柄
- ⑦ 显示屏
- ⑧ 电源插口
- ⑨ 功率调节手柄

## 03/ 显示屏介绍

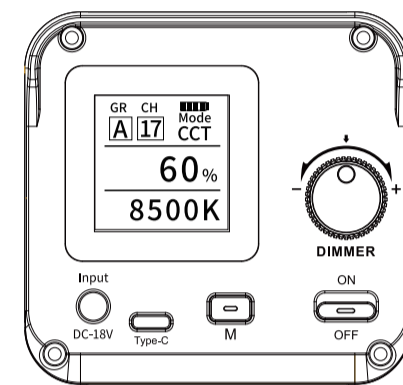

(操作界面)

注:该灯光操作只能调节控制功率, 不能调节控制色温。

### < 灯光操作 >

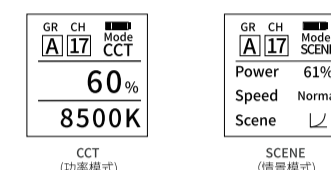

### < 后台操作 >

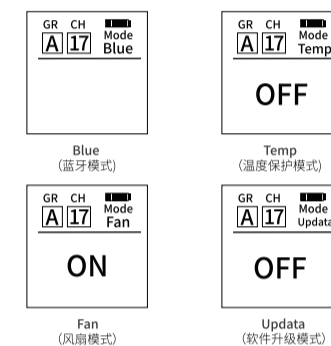

## 04/ 操作介绍

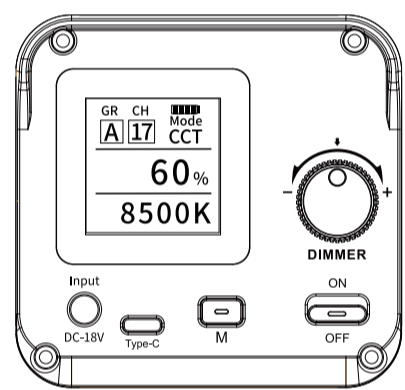

(操作界面)

- 调节控制**  
顺时针旋转: 数值为增加。  
逆时针旋转: 数值为减少。  
按下: 控制项目切换。
- 模式切换键**  
短按: 普通模式界面切换。  
长按: 四个后台模式界面切换。
- Type-C升级插口**  
长按->M键后进入后台模式, 再次短按->M键切换项目。  
将Type-C线与本站连接。  
从官网(www.weeylite.com)将升级文件下载到本机内, 升级完成后自动重启, 重启完成后系统更新完成。
- 电源插口**  
将电源适配器插口连接此处。

## 05/ 手机APP连接



1. 在苹果系统的“APP Store”中搜索“Weeylite”可以找到调光APP并安装到手机。
2. 安卓系统扫描下载“Weeylite”调光APP即可。

### 连接方式

1. 将手机蓝牙保持开启状态下打开手机APP“ Weeylite”将APP的频道号设置为被控灯的频道号一致。(如被控灯频道为1则手机APP组号也为1, 否则无法控制)

2. 将APP组号设置为被控灯的组号。(如被控灯频道号为A则手机APP频道号也为A, 否则无法控制)

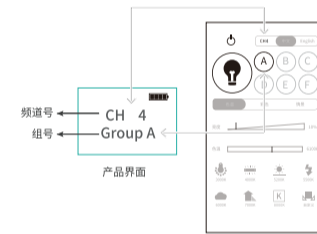
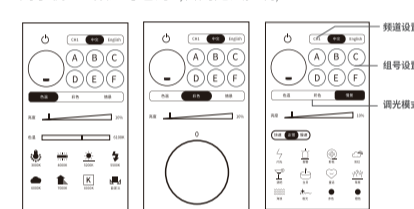

(灯与手机蓝牙APP频道组需一致)

## 06/ 遥控器连接 (需另购)

**CCT**

Mode: CCT

Power: 90%

Hue: 360

SAT: 100

色温模式

**HSI**

Mode: HSI

Power: 90%

Hue: 360

SAT: 100

灯光模式

**RGBW**

Mode: RGBW

R\_100 W\_90

G\_100 Y\_90

B\_100

自由调节模式

**SCENE**

Mode: Scene

Power: 90%

Speed: FAST

Scene: 1

情景模式

注: 该模式为彩色模式, 本产品不支持使用

## 连接方法

1. 长按RC-11“电源开关”2秒, RC-11电源开启, 显示屏点亮。
2. 参照“被控摄影灯”设置成相同的“频道”和“组”, (“频道”和“组”不同是不能操控LED摄影灯的)。
3. 设置频道——长按CH/GRP2秒, +/-键选择需要的频道, 再按“MODE”键确认。
4. 设置组——短按“CH/GRP”, 可以在A/B/C/D/E/F中自由选择。
5. 长按“MODE”键可以在CCT/HSI/RGBW/SCENE 4种模式中切换。HSI/RGBW/SCENE为彩色RGB模式, 该机型可能不支持3种模式去控制它, 请在CCT模式中使用。
6. 按+/-可以调节功率/色温数值大小, 按“MODE”可以在功率/色温等选项中切换。
7. RC-11开机后, 在30分钟内不操作电源会自动关机。

### ⚠ 注意事项:

RC-11 遥控器长时间不使用请取出电池另外保存, 以免电池漏液损坏元器件。

型号	RC-11 遥控器
无线频率	2.4GHz 蓝牙无线控制系统
遥控距离(空旷)	30米
无线遥控分组	A, B, C, D, E, F
频道	1-19
待机时间	30分钟无操作后, 自动关机
环境温度	-10~50°
电源	AAA 1.5V 7号电池
尺寸	101mm×38mm×18mm
重量	约37g (不含电池)

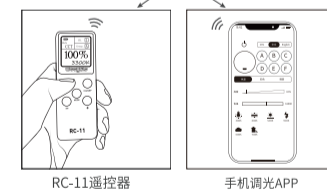
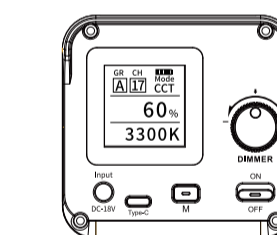

RC-11遥控器 具体操作请看《遥控器使用指南》  
手机调光APP 具体操作请看《APP操作使用指南》

## 07/ 外置电池 (需另购)

充电模式: 向上推-IN键, 插上电源后给锂电池充电。

放电模式: 向下推-OUT键后, 给本产品充电。

双头弯头转换线

效果图

(注: 充电模式下会受适配器功率大小实现快充和普通充电)  
(产品更改并不另行通知, 请与实物为准)

## 08/ 产品信息与注意事项

1. 请勿在近距离对别人的眼睛直接使用补光灯, 否则可能损伤其视网膜。
2. 请勿在较长亮灯过程中, 碰到灯体, 以免烫伤。
3. 请将其他物品放置于距离补光灯15米远处。
4. 请勿使灯体受到强烈振动, 否则可能引起导致元件损坏。
5. 若较长不使用遥控器, 请将遥控器内的电池取出保存。
6. 请勿试图自行拆卸或修理补光灯, 否则可能引起触电或补光灯故障。
7. 请勿将产品置于重物或高温之下, 否则可能导致损坏。
8. 禁止在灯具上覆盖任何影响散热的物品, 过高的温度会缩短LED灯珠使用寿命。
9. 确保灯具稳定, 避免较重的灯具掉落伤害, 避免儿童老人触及本灯具发现冒烟或烧灼即停止操作并取出电池, 以防止补光灯着火或烧灼。
10. 补光灯不得进水, 或者接触到雨水, 水汽防止电路着火和漏电。

型号	ninja 200
色温	2800K-8500K(可调±300)
亮度	0%-100%(可调)
最高光通量	5800lm
最大光亮度	70400lux/0.5m, 15400lux/1m (5500K, 100%亮)
最大功率	60W
分组	1-19
频道	A, B, C, D, E, F
显色指示	CRI ≥ 95, TlCl ≥ 95
DC电源接口	DC18V/3.5A, 5.7*2.5mm
遥控器	RC-11遥控器(需另购)
锂电池	锂电池NP-F960/F970系列(需另购)
尺寸	175x92x85mm
重量	约989.8g
标配附件	补光灯*1 灯罩*1 说明书*1 保修卡*1 电源适配器(AC100-240V~50/60HZ, DC18V/3.5A φ5.7*2.5mm)

执行标准: Q/JYKJ002-2019  
深圳市爵影科技有限公司  
Shenzhen Juying Technology Co., Ltd.  
电话: TEL: +86-755-28719024 传真: FAX: 0755-28714730  
电邮: E-mail: info@weeylite.com 网址: URL: www.weeylite.com  
地址: 深圳市宝安区大铁匠道下和利村安泰科技园4栋4楼2楼  
P11 | © 2019 J. Y. K. & Associates Science and Technology Industrial Park, Kowloon, Hong Kong | www.weeylite.com

weeylite

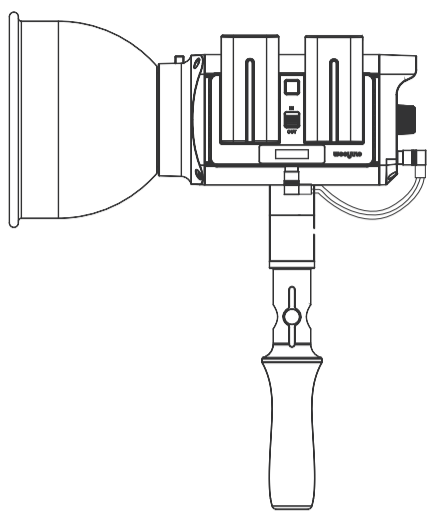

**ninja 200**  
PROFESSIONAL LED LIGHT  
PRODUCT MANUAL

www.weeylite.com

**01/Feature**

Ninja 200, a small and exquisite powerful LED light. It adopts high CRI dual COB bulbs, perfect light effect, accurate color temperature and high power. Perfect for photography, videography, studio, exhibition, make up or other settings which need high demand for light source.

- High CRI dual COB bulbs
- Small and exquisite shape, with 60W power.
- Dual power supply: Li-battery or DC adapter.
- Dot matrix LCD screen, display more intuitive.
- Superior Exhaust fan enable the chip to work at low temperatures, increase the service life
- Multiple dimming methods. Such as LED light body/cellphone APP/bluetooth remote.

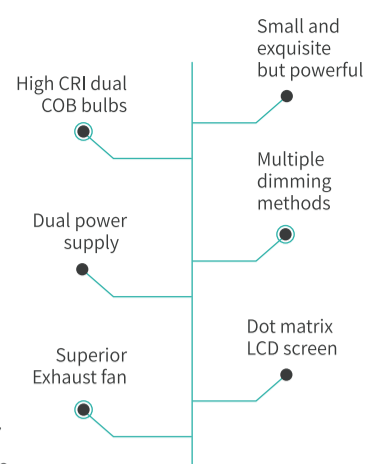

**02/Introduction**

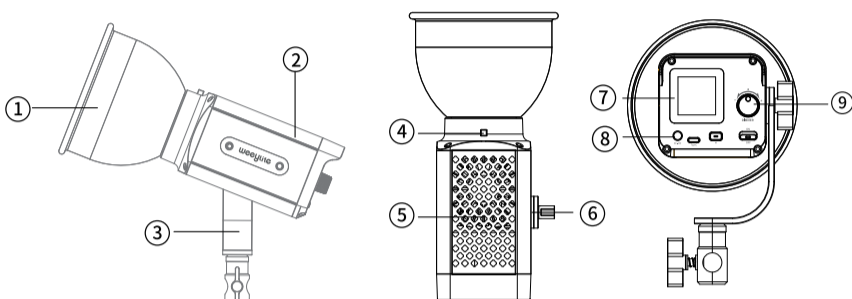

- ① Lampshade
- ② Light body
- ③ Bracket
- ④ Fitting key
- ⑤ Exhaust fan
- ⑥ Handle bar for angle adjustment
- ⑦ Display screen
- ⑧ AC/DC Port
- ⑨ Handle bar for power adjustment

**03/ Display introduction**

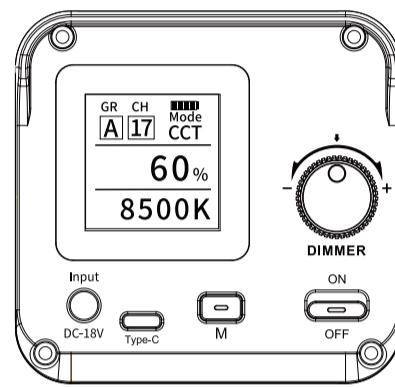

(Operation interface)

Note: The light operation can only adjust the power, but can't adjust the color temperature.

<Lighting operation>

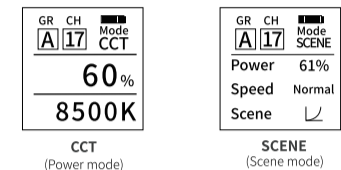

<Background operation>

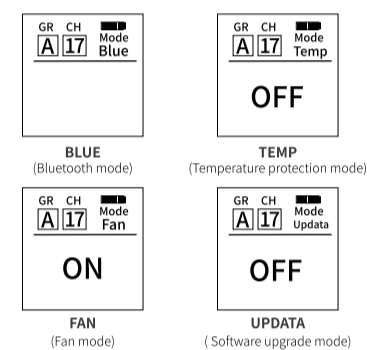

**04/ Operation introduction**

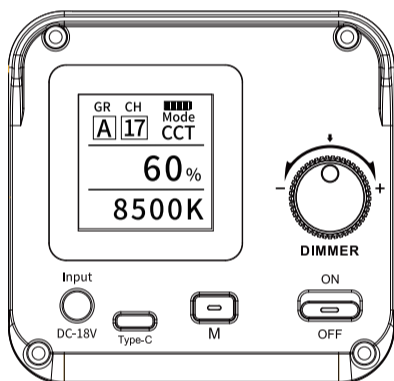

(Operation interface)

- Dimmer**  
Clockwise rotation: the value is increased  
Counter clockwise rotation: the value is decrease  
Press: control cursor switch
- Mode switch key**  
Short press: normal mode interface switch  
Long press: four background mode interface switch
- Type-C upgrade socket**  
Long press the <M> key to enter the background mode, then short press <M> again to switch this item.  
Connect the type-C cable with the unit. Download the upgrade file from the official website (www.weeylite.com) to this light, restart automatically after the upgrade. The systems is updated after the restart.
- Power socket**  
Connect the power adapter here.

**05/ Mobile APP connection**



- Search "Weeylite" in the "APP Store" of Apple OS, find the dimming APP, and download and install it to your phone.
- For Android system, use browser/QQ/We chat to scan QR codes and download "Weeylite" dimming APP.

**Connection**

- Keep the Bluetooth on your mobile phone on, start the APP "Weeylite", and set the channel number of the APP to be the same as the that of the controlled light. (If the channel of the controlled light is 1, the group number of APP will be 1, otherwise it is out of control)
- Set the APP group number to be the same as the group number of the controlled light. (If the channel number of the controlled light is A, the channel number of the mobile APP will be A, otherwise it is out of control)

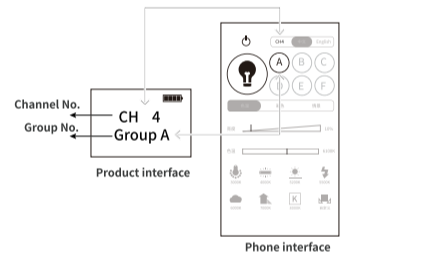
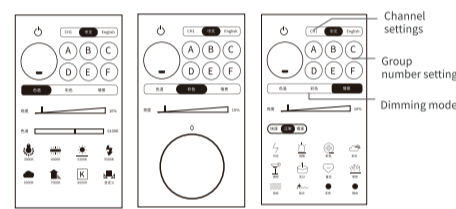

(The light shall be consistent with the Channel No. and Group No. of Bluetooth APP for mobile phones)

**06/ RC-11 Remote control**  
(Purchase separately)

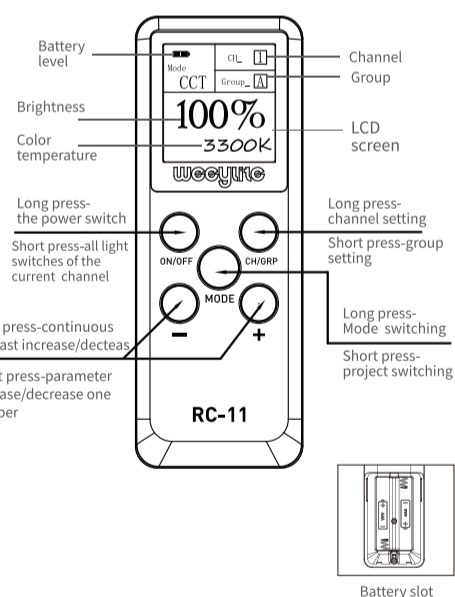

- Battery level
- Brightness
- Color temperature
- Long press- the power switch
- Short press- all light switches of the current channel
- Long press- continuous and fast increase/decrease
- Short press- parameter increase/decrease one number
- Channel Group
- LCD screen
- Long press- channel setting
- Short press- group setting
- Long press- Mode switching
- Short press- project switching
- Battery slot

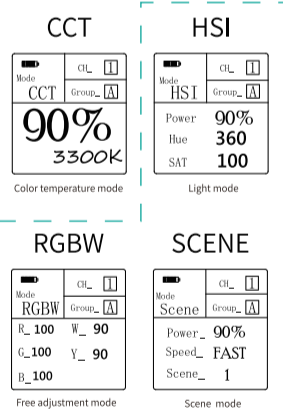

Note: These mode are RGB mode, this products doesn't support.

**Connection**

- Long press on/off button for 2s to turn on the RC-11.
- Setting the light and remote controller to be the same "channel" and "group". (If the channel or group is different, the LED light can not be controlled)  
Channel setting—long press CH / GRP for 2s, select the channel you need by pressing + / - and then press the mode button to confirm it.  
Group setting—short press CH / GRP, select A / B / C / D / E / F freely.
- Long press "MODE" button to switch between CCT / HSL / RGBW / SCENE these 4 modes. HSL / RGBW / SCENE are color RGB mode. Some lights may not support these 3 modes, pls use in CCT mode.
- Press + / - to adjust the power / color temperature. Press the "MODE" button to switch the options such as power / color temperature.
- If there is no operation for 30 minutes, the RC-11 will shut down automatically.

**Precautions**

Please remove the battery when the remote controller is not used for a long time to avoid leaking.

Model	RC-11 Remote control
Frequency	2.4GHz Bluetooth wireless remote system
Control distance (in open air)	30 Meters
Wireless remote group	A, B, C, D, E, F
Channel	1-19
Stand-by time	30minutes without operation, it will off automatic
Environment temperature	-10~50°
Power	AAA 1.5V battery
Dimension	101mm*38mm*18mm
Weight	Approx37g ( exclude batteries )

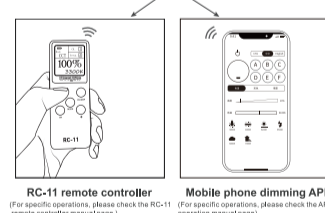
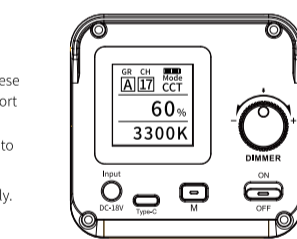

RC-11 remote controller Mobile phone dimming APP  
(For specific operations, please check the RC-11 (For specific operations, please check the APP remote controller manual page) (For specific operations, please check the APP operator manual page))

**07/ External Battery**  
(Purchase separately)

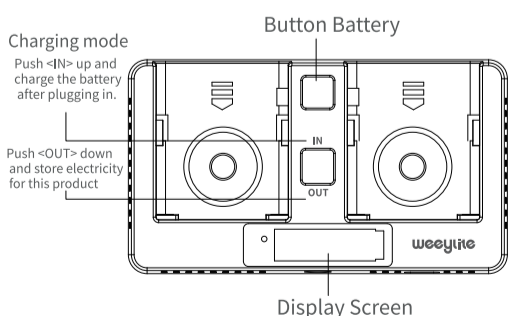

(Note: In charging model, fast charging and ordinary charging can be affected by charging power)  
Product changes will not be further notified, so the actual product shall prevail.

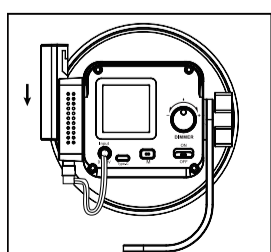
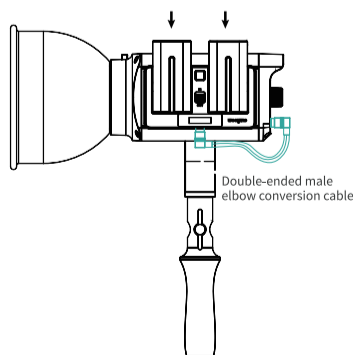

**08/ Product information and Notes**

- Do not use the fill light directly on other people's eye at close range, otherwise it may damage their eyes.
- Do not touch the lamp body after long time lighting process. Pay attention to burns.
- Please put other items 15 meters away from the fill light.
- Do not subject the lamp body to strong vibrations. Otherwise it may cause malfunctions and cause component damage.
- If the remote controller will not be used for a long time, please remove the battery from the remote controller.
- Do not attempt to disassemble or repair the fill light by yourself, otherwise it may cause electric shock or malfunction.
- Do not place the product under heavy objects or high temperature. Otherwise it may cause damage.
- It is forbidden to cover the lamps with anything that affects the heat dissipation. Too high temperature will shorten the life of LED beads.
- Make sure the lamps are stable, avoid heavy lamps from falling, and avoid children and the elderly to touch this lamp. If smoke or burning odor is found, immediately stop operation and unplug the power supply to prevent supplemental fire or burning.
- The lamp not be flood or with rain water, it may cause explosion or fire.

Model	ninja 200
Color temperature	2800K-8500K(adjustable) ±300
Brightness	0%-100%(adjustable)
Max.luminous flux	5800lm
Max.illuminance	70400lux/0.5m, 15400lux/1m (5500K, 100%Full)
Power(max.)	60W
Channel	1-19
Group	6 Groups (A,B,C,D,E,F)
Color rendering index	CRI ≥95, TLCI ≥95
DC adapter interface	DC18V/3.5A, φ5.5*2.5mm
Remote controller	RC-11 Remote controller(purchase extra)
Lithium battery	Li-battery NP-F960/F970 series
Dimension	175x92x85mm
Weight	≈989.8g
Stabdard Accessory	Light*1 Lampshade*1 Manual*1 Warranty Card*1 DC Adapter (AC100-240V-50/60HZ,DC18V/3.5A φ5.5*2.5mm)

Standard: Q/JYKJ002-2019  
Shenzhen Jueying Technology Co.,Ltd.  
TEL: +86-755-2877 9024 FAX: 0755-2877 4730  
E-mail: info@weeylite.com URL: www.weeylite.com  
FTR: 2/F, B4, B400 Science and Technology Industrial Park, Xixiangmiao, Daxiang Street, Longhua District, Shenzhen, China